

PLOTTED: 6/7/2019  
 Z:\2017\1702M0027\...CULVERT\_SITES\3-914A\_SR16BEACH\CADD\MICROSTATION\ROADWAY\CP-05\_3-914A.DGN

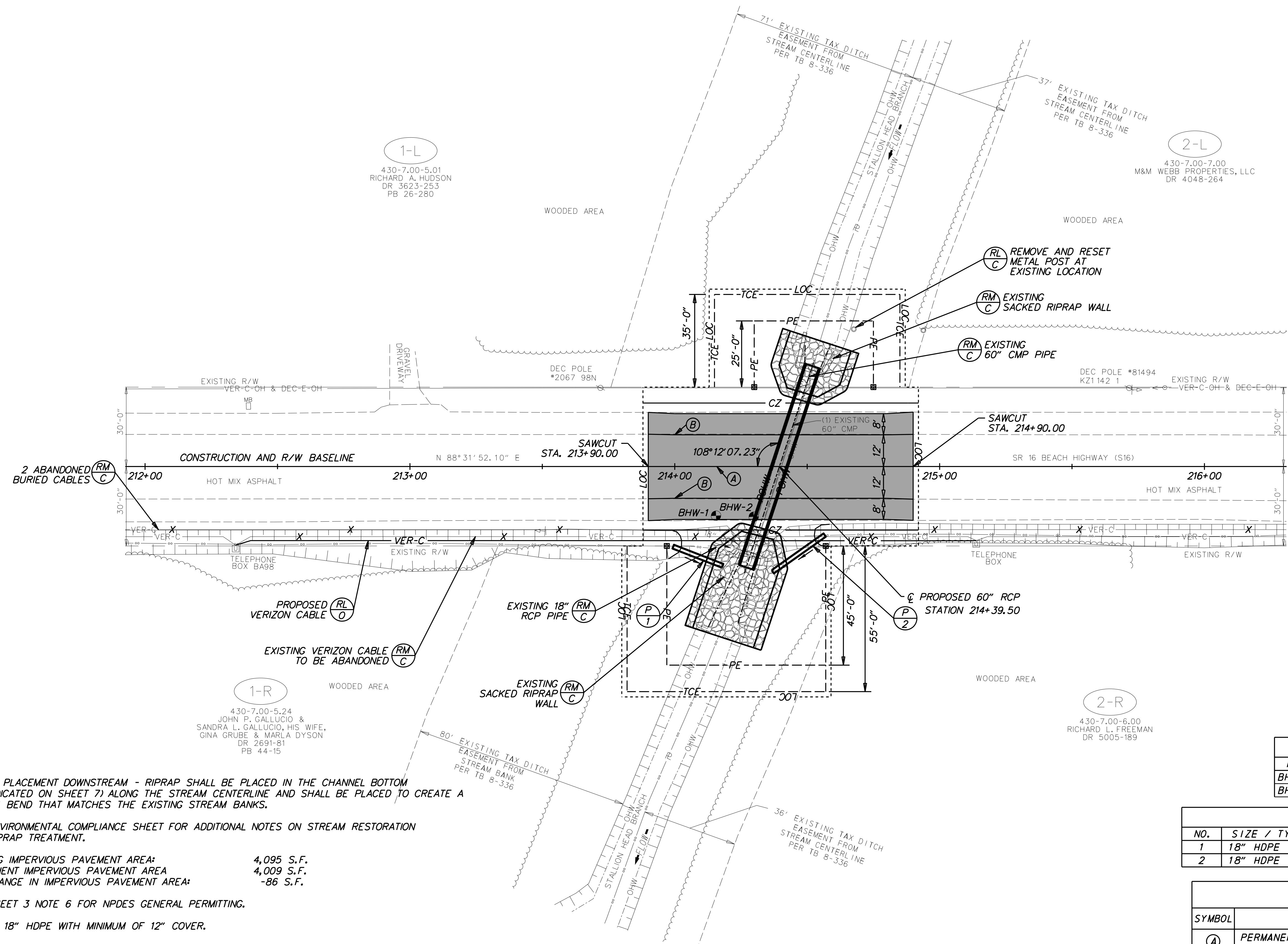

- NOTES:**
- RIPRAP PLACEMENT DOWNSTREAM - RIPRAP SHALL BE PLACED IN THE CHANNEL BOTTOM (AS INDICATED ON SHEET 7) ALONG THE STREAM CENTERLINE AND SHALL BE PLACED TO CREATE A SMOOTH BEND THAT MATCHES THE EXISTING STREAM BANKS.
  - SEE ENVIRONMENTAL COMPLIANCE SHEET FOR ADDITIONAL NOTES ON STREAM RESTORATION AND RIPRAP TREATMENT.
  - EXISTING IMPERVIOUS PAVEMENT AREA: 4,095 S.F.  
 PERMANENT IMPERVIOUS PAVEMENT AREA: 4,009 S.F.  
 NET CHANGE IN IMPERVIOUS PAVEMENT AREA: -86 S.F.
  - SEE SHEET 3 NOTE 6 FOR NPDES GENERAL PERMITTING.
  - INSTALL 18" HDPE WITH MINIMUM OF 12" COVER.
  - THE "LOC" AND "TCE" IS THE SAME LINE BUT THE "LOC" IS SHOWN OFFSET 2' FOR CLARITY.
  - THE LOC MAY BE REDUCED AT THE DISCRETION OF THE CONTRACTOR TO LIMIT THE DISTURBANCE TO WOODED AREAS AND OTHER FEATURES. REDUCTIONS TO THE LOC WILL BE DETERMINED DURING THE ONSITE PRECONSTRUCTION MEETING.

RIPRAP SCHEDULE		
LOCATION	TYPE	AREA/SF
UPSTREAM	R-4	642.00
DOWNSTREAM	R-4	1235.00

SOIL BORING SCHEDULE			
NO.	STATION	OFFSET	DESCRIPTION
BHW-1	214+15.60	18.57	SEE SOIL BORING LOG
BHW-2	214+29.84	18.94	SEE SOIL BORING LOG

DRAINAGE PIPE SCHEDULE						
NO.	SIZE / TYPE	CLASS	LENGTH	SLOPE	INT. EL.	DIS. EL.
1	18" HDPE	S	20.00	0.50%	43.50	43.40
2	18" HDPE	S	24.00	0.50%	43.50	43.38

PAVEMENT MARKINGS LEGEND		
SYMBOL	ITEM	QUANTITY
(A)	PERMANENT PAVEMENT STRIPING, EPOXY RESIN PAINT, YELLOW, 5" (ITEM 817013)	100 LF
(B)	PERMANENT PAVEMENT STRIPING, EPOXY RESIN PAINT, WHITE, 5" (ITEM 817013)	200 LF



ADDENDUMS / REVISIONS

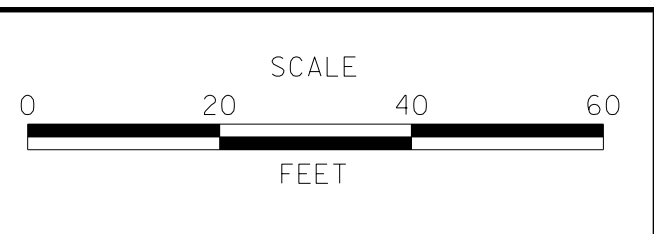

**DESIGN-BUILD STATEWIDE  
 PIPE REPLACEMENT PROJECT  
 (BR 3-914A ON SR 16 BEACH HIGHWAY)**

CONTRACT	BRIDGE NO.	<b>3-914A</b>
T201607002	DESIGNED BY:	HLW
COUNTY	CHECKED BY:	KSJ
SUSSEX		

<b>CONSTRUCTION PLAN</b>	SHEET NO.	5
	TOTAL SHTS.	13